

OGL LED SATURN 60 down lights Installation Instruction

Applicable for Part Numbers:

CS110-W09-W-R, CS110-N09-W-R, CS110-W09-VW-R, CS110-N09-VW-R

1. Product description – technical data

Product description	Part Number	LED Power	Colour Temp	Lumens output	Beam Angle	CRI	Dimmable	Mechanical Data
SATURN - OGL LED down light 11.5 Watt Dimmable external driver 240V AC	CS110-W09-W	9 Watt	3,000K	850lm	60deg	>80	YES	Diameter: 110mm Height: 25mm White frame
	CS110-W09-VW	9 Watt	3,000K	850lm	100deg	>80	YES	
	CS110-N09-W	9 Watt	4,000K	900lm	60deg	>80	YES	
	CS110-N09-VW	9 Watt	4,000K	900lm	100deg	>80	YES	

Product description	Operating temp	IP rating	LED Efficacy	Compliance	
SATURN - OGL LED down light 11.5 Watt Dimmable external driver 240V AC	-20/+50deg C	IP20	94lm/W		CE, C-tick
	-20/+50deg C	IP20	94lm/W		CE, C-tick
	-20/+50deg C	IP20	100lm/W		CE, C-tick
	-20/+50deg C	IP20	100lm/W		CE, C-tick



LED 100deg



LED 60deg



Dimmable Driver

2. Dimming feature

For OGL LED Saturn dimmable down lights should be use Clipsal LED Dimmer only - P/N: **32ELEDM**.

3. Installation instruction

This series of OGL LED SATURN 60 AC down lights have to be installed according to Wiring Rules Standard AS/NZS 3000 : 2007 by Licensed Electrician.

The down light is equipped with Australian mains cable and 3-pin plug to be connected directly to 240V AC 50 Hz and must be connected to Earth.

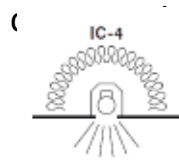

OGL LED SATURN down lights meet AS/NSZ 3000 : 2007 :

(i) (B) and AS/NZS 60598.2.2 and can be installed covered with glass wool insulation up to R6 rating (inclusive), providing that insulation meets AS1530.1 standard.

For details on installation please refer to the diagram below:

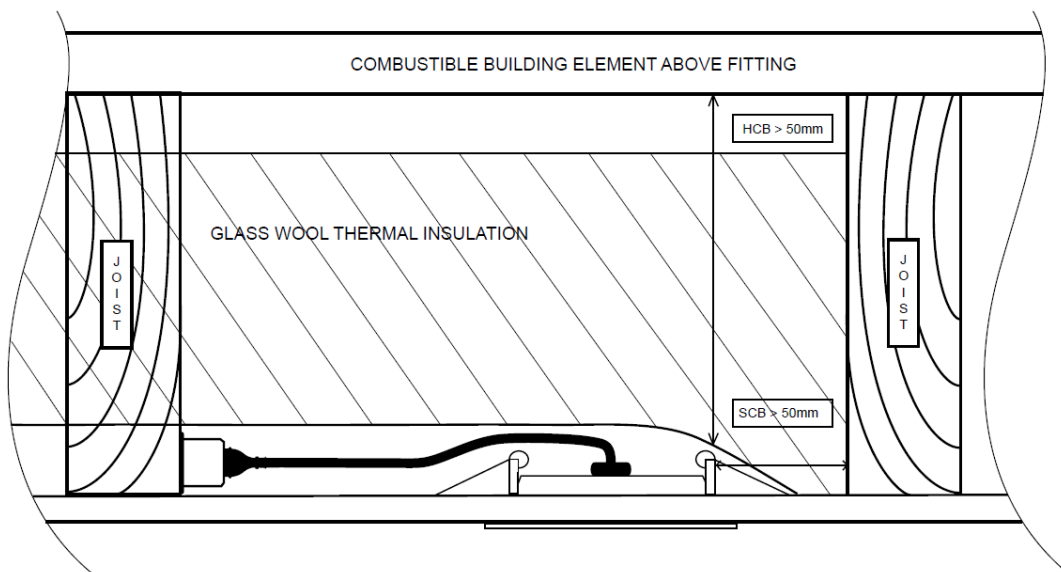

Abbreviation	Minimum clearances for OGL LED	Distance in mm
SCB	Side Clearance to building elements	50
HCB	Height Clearance to building elements	50

4. Disclaimers

- 4.1. This product must be installed and used as per these instructions.
- 4.2. This product to be installed internally only according to its IP rating.
- 4.3. This product is not suitable for installation in hazardous and/or corrosive areas.
- 4.4. This product contains no serviceable parts and no attempt should be made to repair this product.
- 4.5. This product has been designed to minimise the effect of transient voltage in electrical installation, but may not give full protection for extreme over-voltage transients such as those resulting from a close lightning strike.
- 4.6. The material in this product may vary in colour from batch to batch and colour matching from one batch to another can not be guarantee.
- 4.7. OGL reserves the rights to modify the specification of this product at any time.

5. Customer Service

For all Customer and Technical Support please send email to:

web@green-lighting.com.au

OGL Pty Ltd T/A Green Lighting
www.green-lighting.com.au